



5 Ashton Gardens, Huntingdon
Cambridgeshire. PE29 1JE

Asking Price
£175,000

Located close to Huntingdon town centre this terraced house has sitting room, kitchen/dining room, two bedrooms, a bathroom, gardens to the front and rear, a garage and parking space. Offered for sale with no forward chain.

Full details

The front door leads into an entrance porch with window to the side and a door to the sitting room.

Sitting Room – 3.76m x 3.57m (12'4 x 11'9)

Window to the front, radiator, stairs to the first floor and a door to the kitchen/diner.

Kitchen/Dining Room – 3.57m x 3.24m (11'9 x 10'8) max

Fitted with a range of base, wall & Drawer units with a sink & drainer, an electric oven, grill & hob with extractor over, plumbing for a washing machine, a storage cupboard, wall mounted gas central heating boiler, a window and door to the rear.

Landing

Doors to the bedrooms and the bathroom.

Bedroom One – 3.76m x 3.57m (12'4 x 11'9) max

Two windows to the front and a radiator.

Bedroom Two – 2.22m x 2.12m (7'3 x 7'0)

Window to the rear and a radiator.

Bathroom

Window to the rear, bath with shower over, WC, wash basin, radiator and a door to the airing cupboard with hot water cylinder.

Outside

To the front is an open plan front garden, to the rear an enclosed back garden. There is a garage in a block and a parking space at the end of the row.

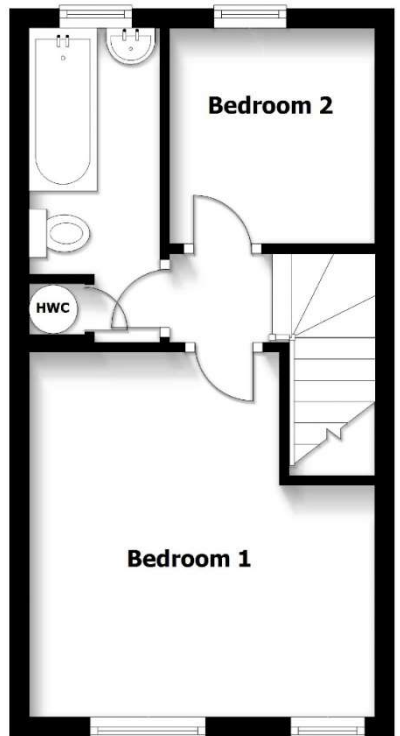
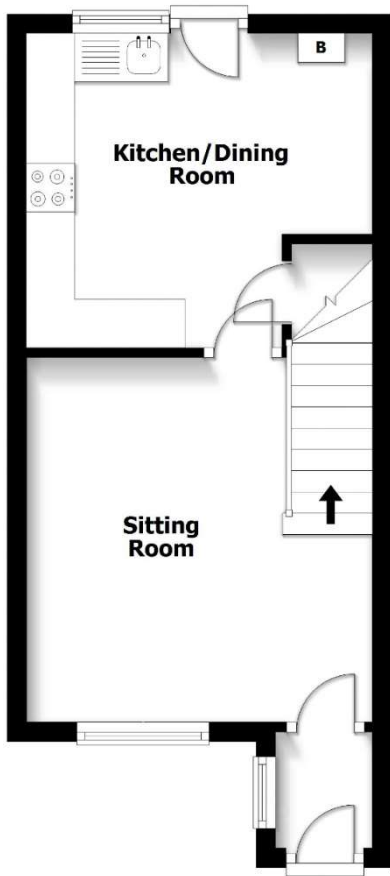

Video Tour link: <https://youtu.be/EOGAB4Ofjy4>

IMPORTANT NOTICE: These particulars are intended only as a guide to the property. They do not form part of any sale contract and although believed to be correct they may be inaccurate in important respects including dimensions and/or other measurements relating to the size of rooms, buildings and any garden.

The floorplans should only be viewed in conjunction with the sales particulars; they are for indicative purposes only and are not to scale. Dimensions, walls, windows, doors, fixtures & fittings and their locations are for identification only; they may be inaccurate in important respects and may not be a true representation.

